

FLEXGUARD

PVC WATERBAR

FLEXGUARD PVC WATERBAR IS RECOMMENDED TO USE IN INTERNAL AND EXTERNAL CONCRETE CONSTRUCTION AND EXPANSION JOINTS TO PREVENT OF WATER SEEPAGE THROUGH THE JOINT.



TYPICAL USES

- **RETAINING WALLS. BASEMENT AND TUNNELS.**
- **SWIMMING POOLS. WATER RESERVOIRS.**
- **WATER SEWAGE TREATMENT PLANTS.**
- **CULVERTS. BRIDGES. DAMS AND OTHER UNDERGROUND STRUCTURES...**

FLEXGUARD PVC WATERBAR

Product description

FLEXGUARD PVC WATERBAR is manufactured from premium quality thermoplastic resins, which are plasticized and stabilized for controlled properties. For consistent quality, no reclaimed PVC is used. They are extruded in a variety of thicknesses, widths and centre bulb sizes, internal and external construction joints application.



Product shapes and dimension (mm).

V	W	O	C	KC	KW
160	150	150	150	150	150
200	200	200	200	200	200
250	250	250	250	250	250
320	330	320	330	350	350

Standard requirement according to JIS K6773-2007.

Characteristics	Result
Shore A hardness	> 65
Density	≥ 1400 kg/m ³
Tensile strength	≥ 12.0 Mpa
Elongation at break	≥ 250%
Chemical resistance immersion test	
Alkaline at 70°C for 14 days.	
Rate of mass change	± 5%
Rate of tensile strength change	± 20%
Rate of Elongation change	± 20%
Brine at 25°C for 14 days.	
Rate of mass change	± 2%

Rate of tensile strength change	± 10%
Rate of elongation change	± 10%

**FLEXGUARD PVC WATERBAR
PRODUCT RANGES**

V & W - Shapes	O & C – Shapes
<p>W150 150 mm</p> <p>W200 200 mm</p> <p>W250 250 mm</p> <p>Internal use</p>	<p>C150 150 mm</p> <p>C200 200 mm</p> <p>C250 250 mm</p> <p>C330 330 mm</p> <p>Internal expansion joint</p>

KW - Shapes	KC – Shapes
<p>KW150 150 mm</p> <p>KW200 200 mm</p> <p>KW250 250 mm</p> <p>KW330 330 mm</p>	<p>KC150 150 mm</p> <p>KC200 200 mm</p> <p>KC250 250 mm</p>

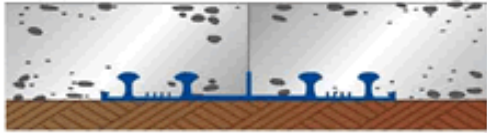

External construction Joint



External expansion Joint

ACCESSORIES

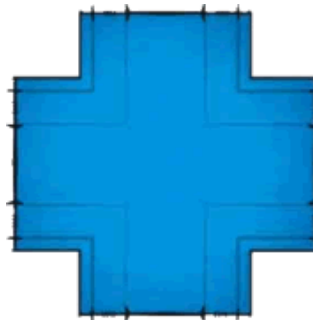
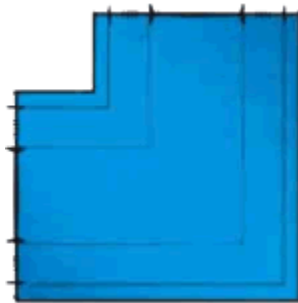
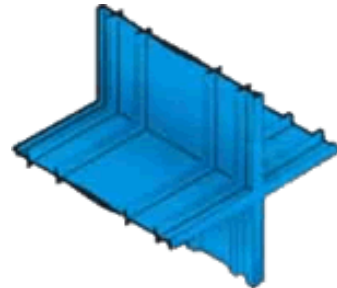
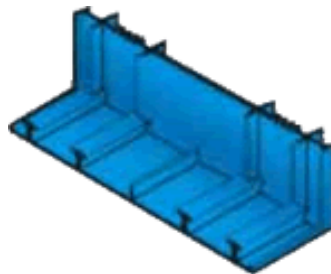
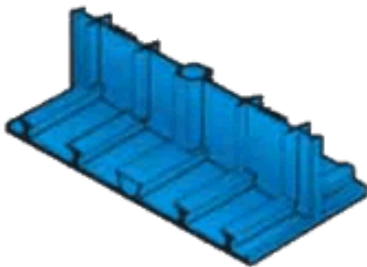
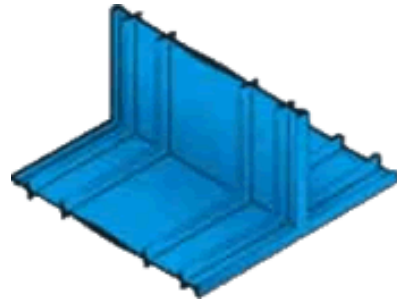
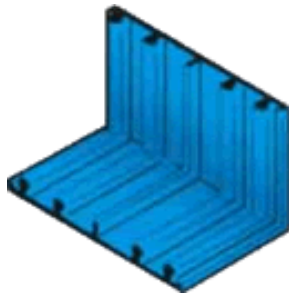
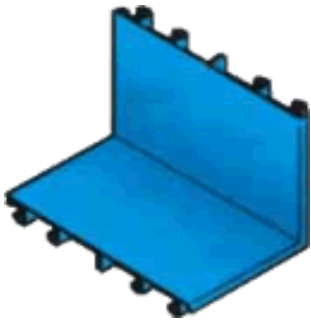

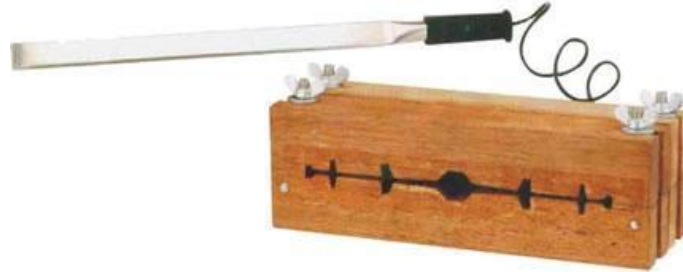

Heater blades & jointing jigs

Flexguard PVC waterbar 2015-1 edition. Issued 2015 March.

Adchem

Advanced Building Chemical